

Getting started with

# Car Paint Colours

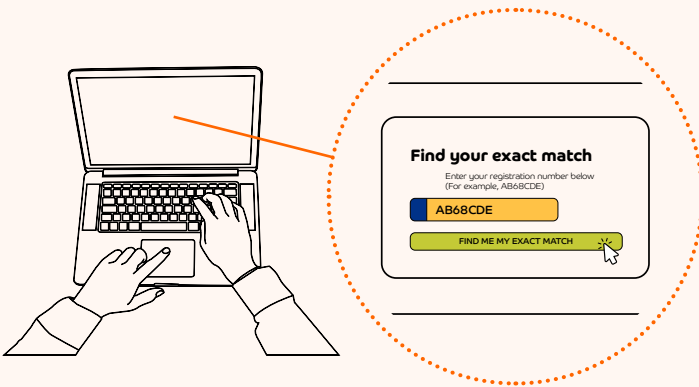

## Order your perfect paint match online in minutes

Simply enter your car's reg plate number in the search bar on our homepage. Our DVLA-assisted technology will instantly identify your vehicle and create the exact paint colour. You'll need to choose a paint kit depending on your desired outcome. You can further customise your project with our optional add-on products.

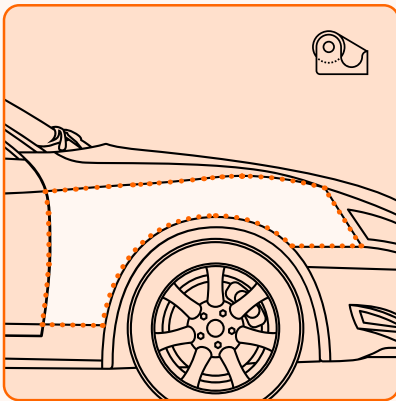

### Step 1: Mask like a pro

Masking is essential to protect your car's original paint from overspray and sanding scratches. It's important to overlap each piece of tape slightly to create a solid line. For intricate details, apply multiple layers of fine line tape. It's important to be patient! Rushing this step can lead to uneven lines.

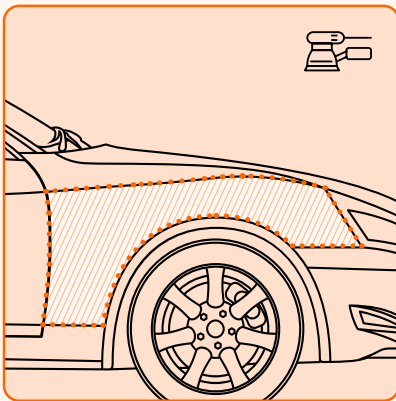

### Step 2: Sanding for a smooth finish

Achieve a professional, smooth finish before spraying by sanding. This essential step removes imperfections and blemishes, creating an even area for your new paint. Use light, even pressure and focus on edges and curves. Once you've finished sanding, wipe down the area thoroughly to remove any dust or residue that could affect the paint adhesion.

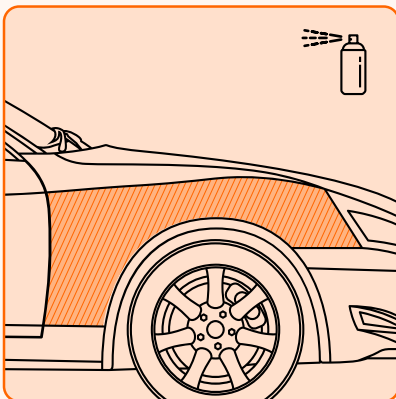

### Step 3: Prime for a perfect finish

Priming is an essential step before spraying for a long-lasting, professional finish. Hold the aerosol spray primer 8-12 inches away and spray light, even coats in a sweeping motion, overlapping slightly to avoid missed spots.

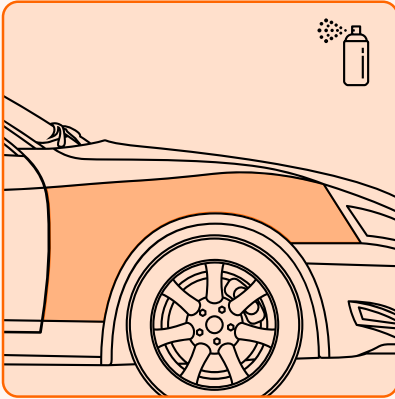

## Step 4: Colour like a pro

Once the primer has set, it's time to begin the colour coat. Maintain a consistent distance of 8-12 inches for optimal control and even application. Remember, multiple thin coats is the best, this helps prevent drips, runs, and ensures a smoother finish.

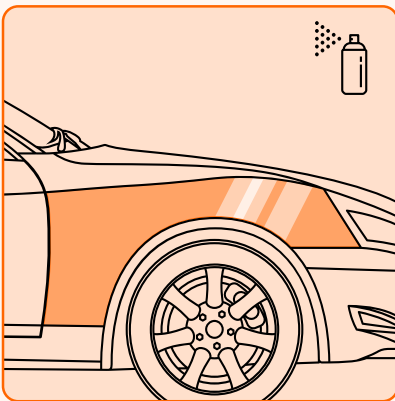

## Step 5: Applying the clear coat

The clear coat acts as the final layer, protecting your new paint job from the elements and adding a shine. As you move across a panel, focus on keeping a "wet edge" where the fresh clear coat meets the previously sprayed area. This ensures a seamless transition.

---

## Hints & Tips:

### Tip:

Patience is key! Take your time and focus on even application. A little extra time spent now will result in a professional-looking finish.

### Hint:

Do light checks... Good lighting is essential! It helps you identify any uneven application or missed spots.

### Tip:

Less is more... When spraying, it's better to apply multiple thin coats than one thick coat. This helps prevent drips, runs, and ensures a smoother finish.

### Hint:

Peel back the masking tape slowly after the final coat has dried, this helps prevent a sharp line of fresh vs older paint.

### Tip:

Create a spray zone: Use plastic sheeting to create a temporary spray booth around your car. This keeps dust and debris at bay for a professional finish.